



ORIENTAL HOTEL
OKINAWA RESORT & SPA

Floor Plan



| Guest Room Floors 5~15F



Superior

- Room Location 5-7F
- Number of Rooms 72 rooms
- Capacity 5 people

- Floor Space 44.6㎡
- Bed Size 1400×2000mm

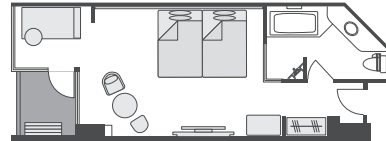

High Floor Superior

- Room Location 8-13F
- Number of Rooms 144 rooms
- Capacity 4 people

Universal

- Room Location 5-7F
- Number of Rooms 12 rooms
- Capacity 5 people

- Floor Space 46.3㎡
- Bed Size 1400×2000mm

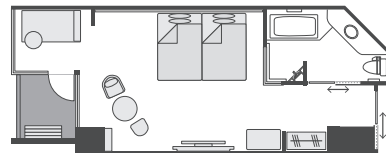

High Floor Universal

- Room Location 8-13F
- Number of Rooms 24 rooms
- Capacity 4 people

Club Room

- Room Location 14-15F
- Number of Rooms 56 rooms
- Capacity 3 people
- Floor Space 44.6m²
- Bed Size 1400×2000mm

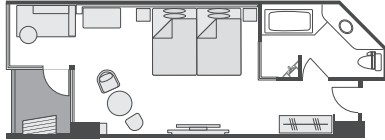

Club Corner

- Room Location 8-13F
- Number of Rooms 12 rooms
- Capacity 4 people
- Floor Space 64.9m²
- Bed Size 1400×2000mm

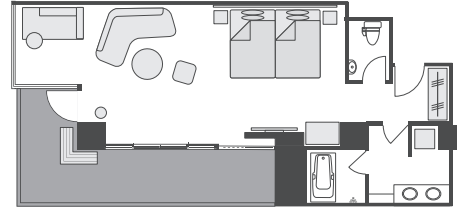

Club Corner Premium

- Room Location 14-15F
- Number of Rooms 4 rooms
- Capacity 4 people

Superior Grande

- Room Location 5-7F
- Number of Rooms 12 rooms
- Capacity 4 people
- Floor Space 64.9 - 68.4m²
- Bed Size 1400×2000mm

*There are two types of Superior Grande Rooms.

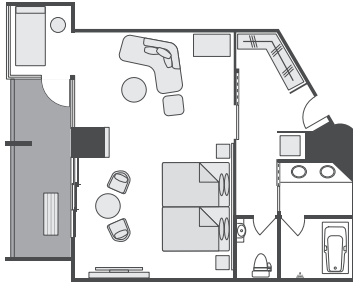

Club Ocean

- Room Location 8-13F
- Number of Rooms 12 rooms
- Capacity 4 people

- Floor Space 68.4m²
- Bed Size 1400×2000mm

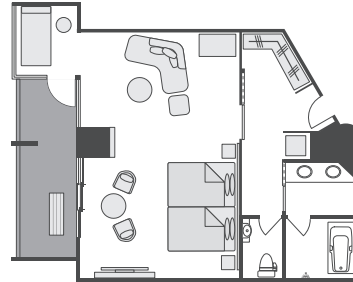

Club Ocean Premium

- Room Location 14-15F
- Number of Rooms 2 rooms
- Capacity 4 people

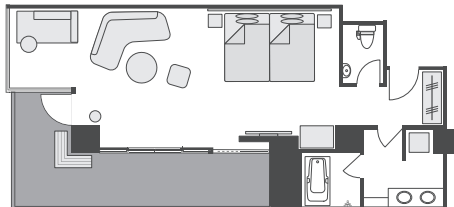

Panorama Ocean Suite

- Room Location 5-9F
- Number of Rooms 5 rooms
- Floor Space 109.0m²
- Capacity 4 people
- Bed Size 1400×2000mm

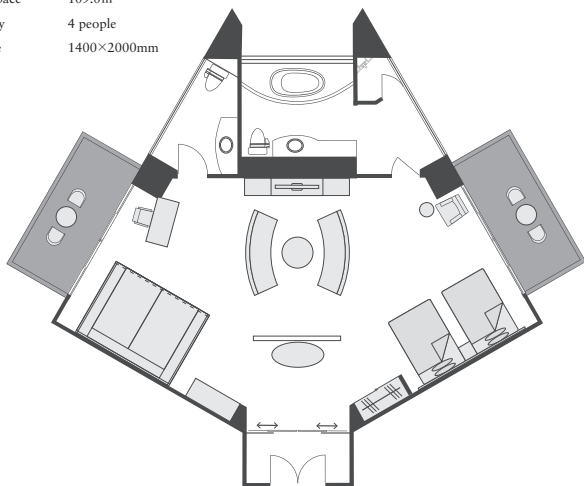

Panorama Ocean Suite Premium

- Room Location 10-13F
- Number of Rooms 4 rooms
- Floor Space 109.0m²
- Capacity 4 people
- Bed Size 1400×2000mm

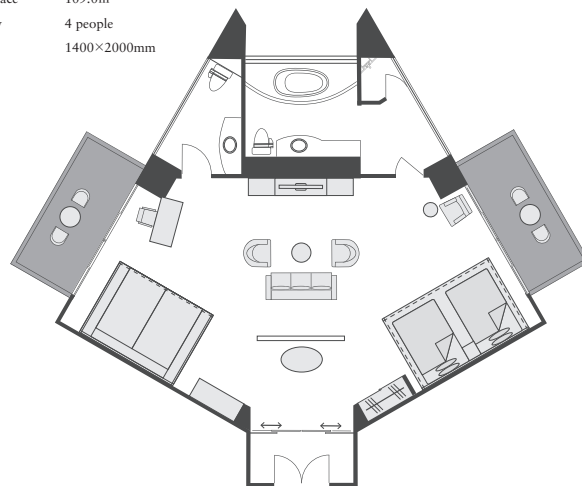

Crown Suite

- Room Location 14F
- Number of Rooms 1 room
- Floor Space 109.0m²
- Capacity 2 people
- Bed Size 1800×2000mm

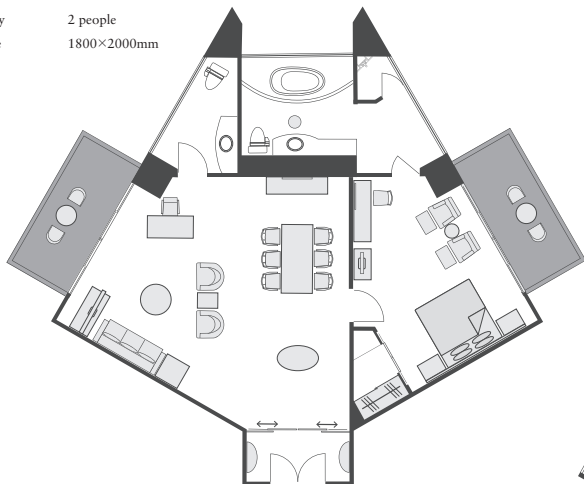

Royal Suite

- Room Location 15F
- Number of Rooms 1 room
- Floor Space 249.3m²
- Capacity 4 people
- Bed Size 1400×2000mm
- Bed Size 1800×2000mm

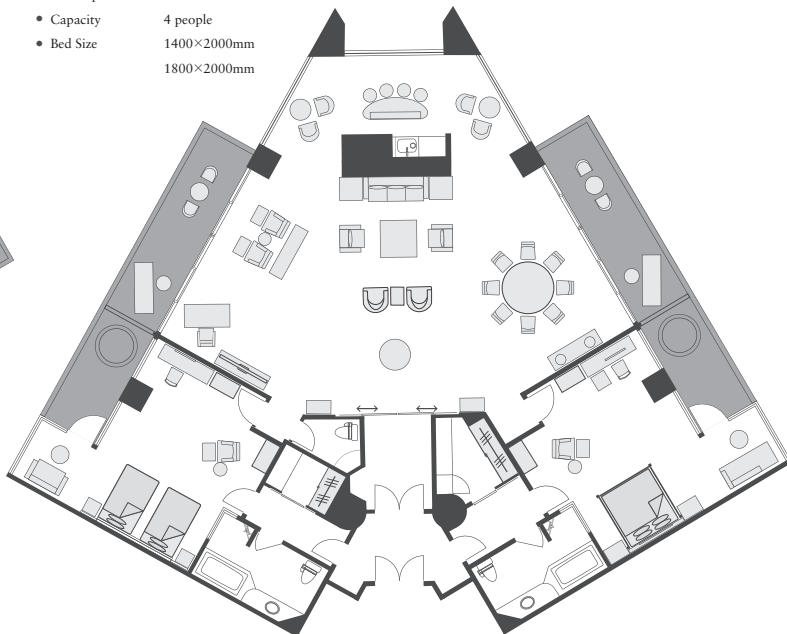

| Lobby Floor 2F

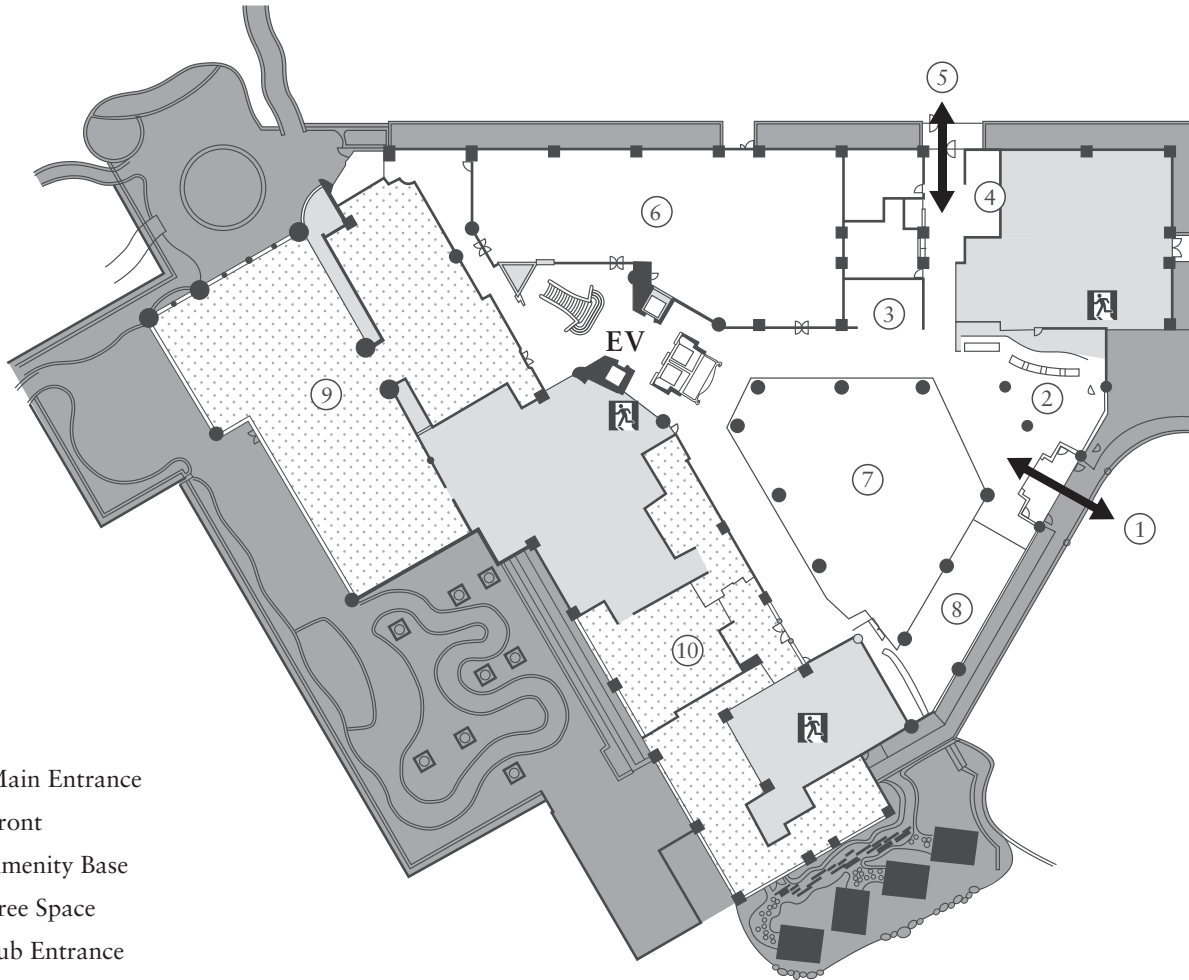

- ① Main Entrance
- ② Front
- ③ Amenity Base
- ④ Free Space
- ⑤ Sub Entrance
- ⑥ Shop
- ⑦ Club Lounge
- ⑧ Lobby Lounge
- ⑨ Restaurant (Buffet Restaurant)
- ⑩ Restaurants (Okinawa Yakiniku / Chinese Dining / Okinawan Dining)

| Restaurants

Okinawa Yakiniku • Capacity 42 seats

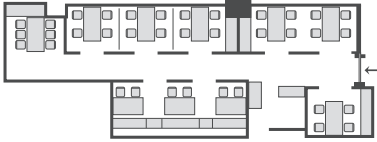

Chinese Dining • Capacity 79 seats

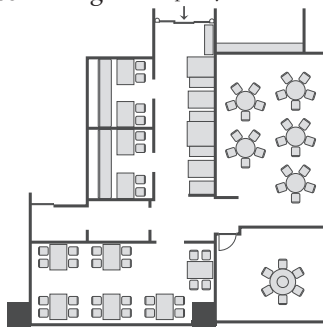

Okinawan Dining • Capacity 84 seats

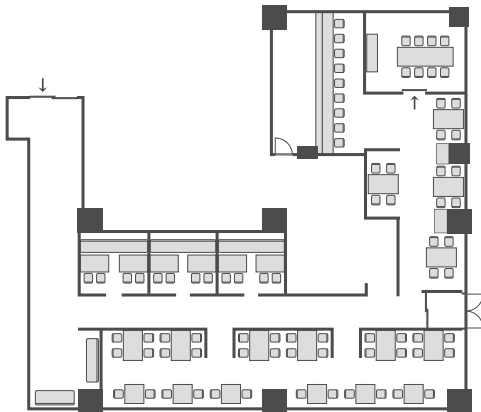

Buffet Restaurant • Capacity 346 seats (including additional free space 114 seats)

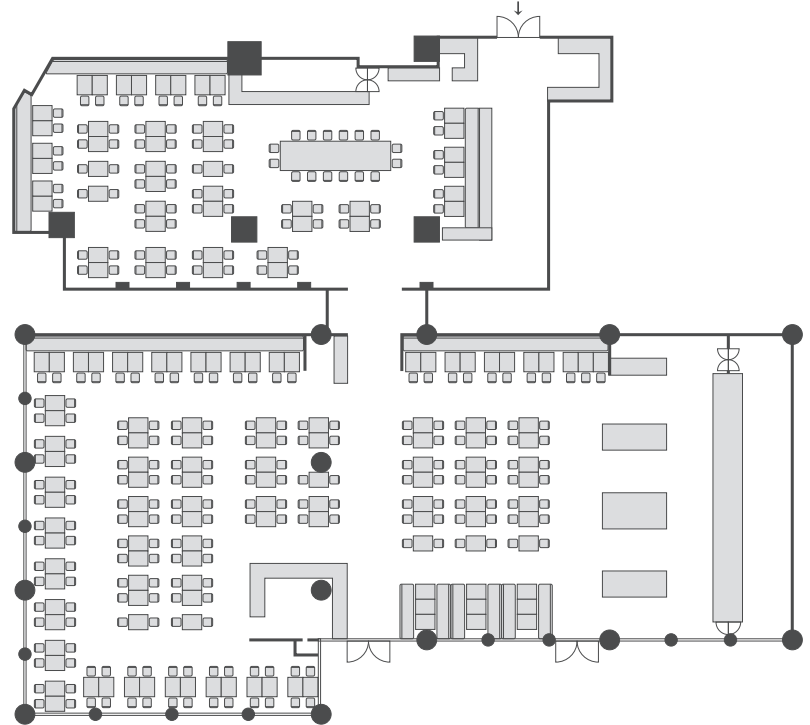

| Banquet Rooms 3F

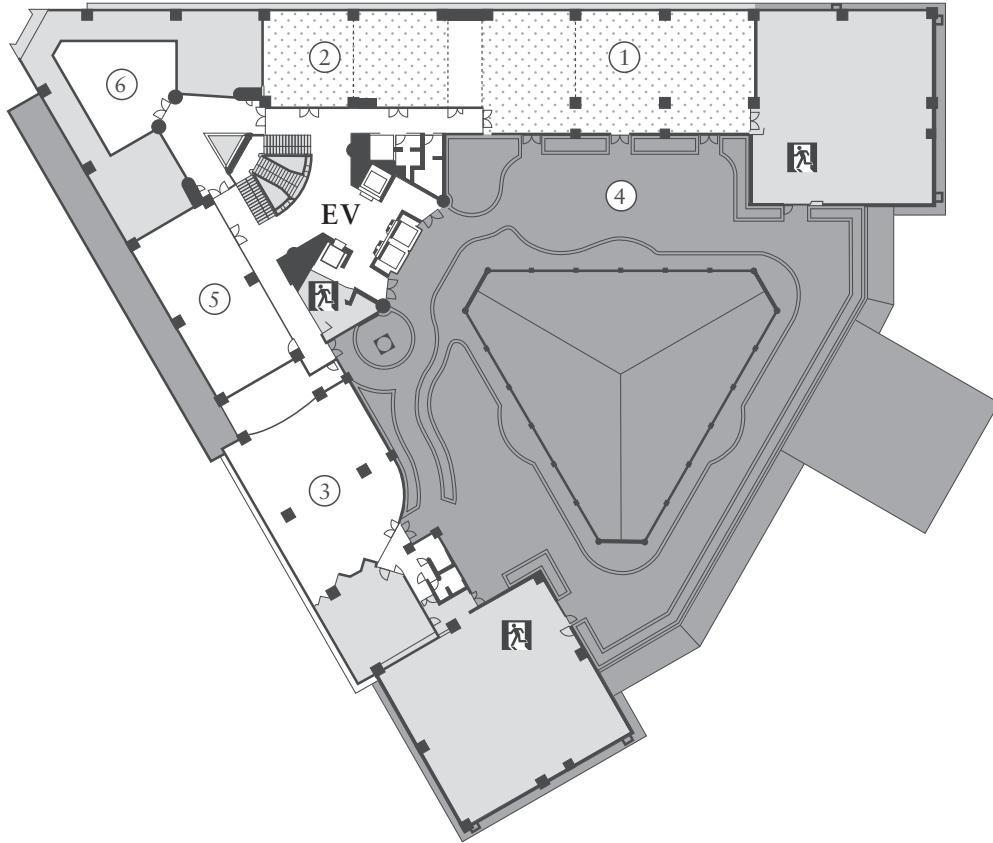

- ① Umanchu
- ② Majun
- ③ Karee
- ④ Courtyard
- ⑤ Bridal Salon
- ⑥ Chapel

| Banquet Hall

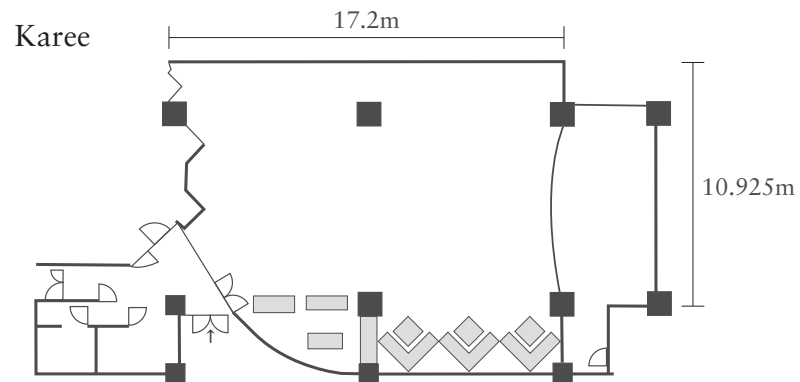
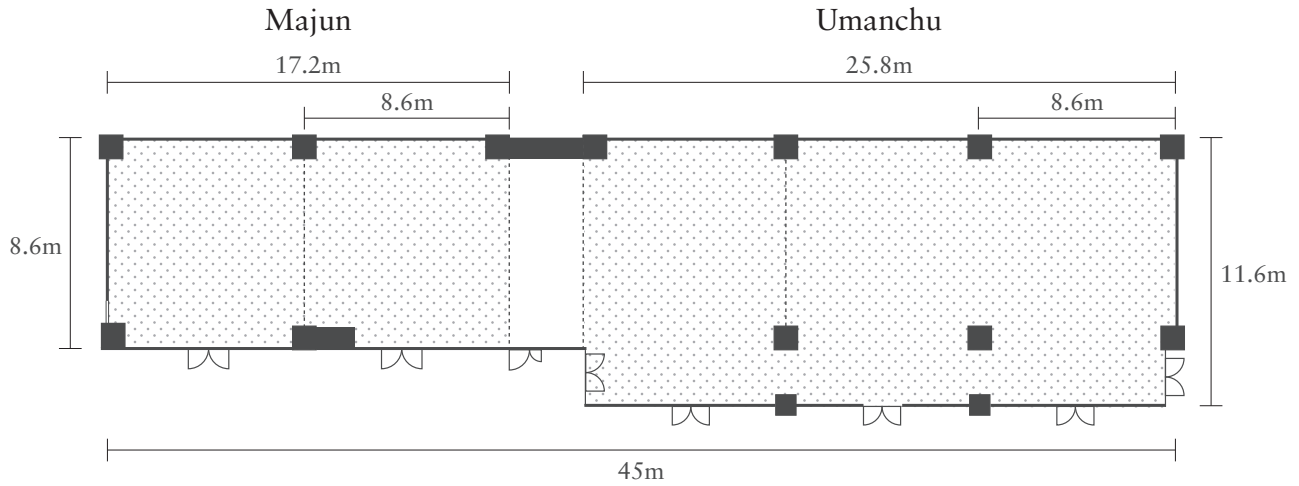

| Banquet Room Name | Floor | Standing | Formal Setting | Seated | School Style | Theater Style | m | Area (m ²) | Ceiling Height |
|-------------------|-------|----------|----------------|--------|--------------|---------------|----------|------------------------|----------------|
| Umachu | 3F | 150 | 104 | 130 | 117 | 200 | 8.6×25.8 | 299 | 3.5 |
| Majun | 3F | 80 | 56 | 70 | 72 | 100 | 8.6×17.2 | 148 | 3.5 |
| Umachu + Majun | 3F | 280 | 192 | 240 | 198 | 310 | 8.6×45.0 | 456 | 3.5 |
| Karee | 3F | 120 | 64 | 100 | 72 | 130 | 8.6×21.5 | 185 | 3.5 |
| Poolside | 1F | 250 | - | 200 | - | - | 7.5×48.0 | 480 | - |

| Garden Pool 1F

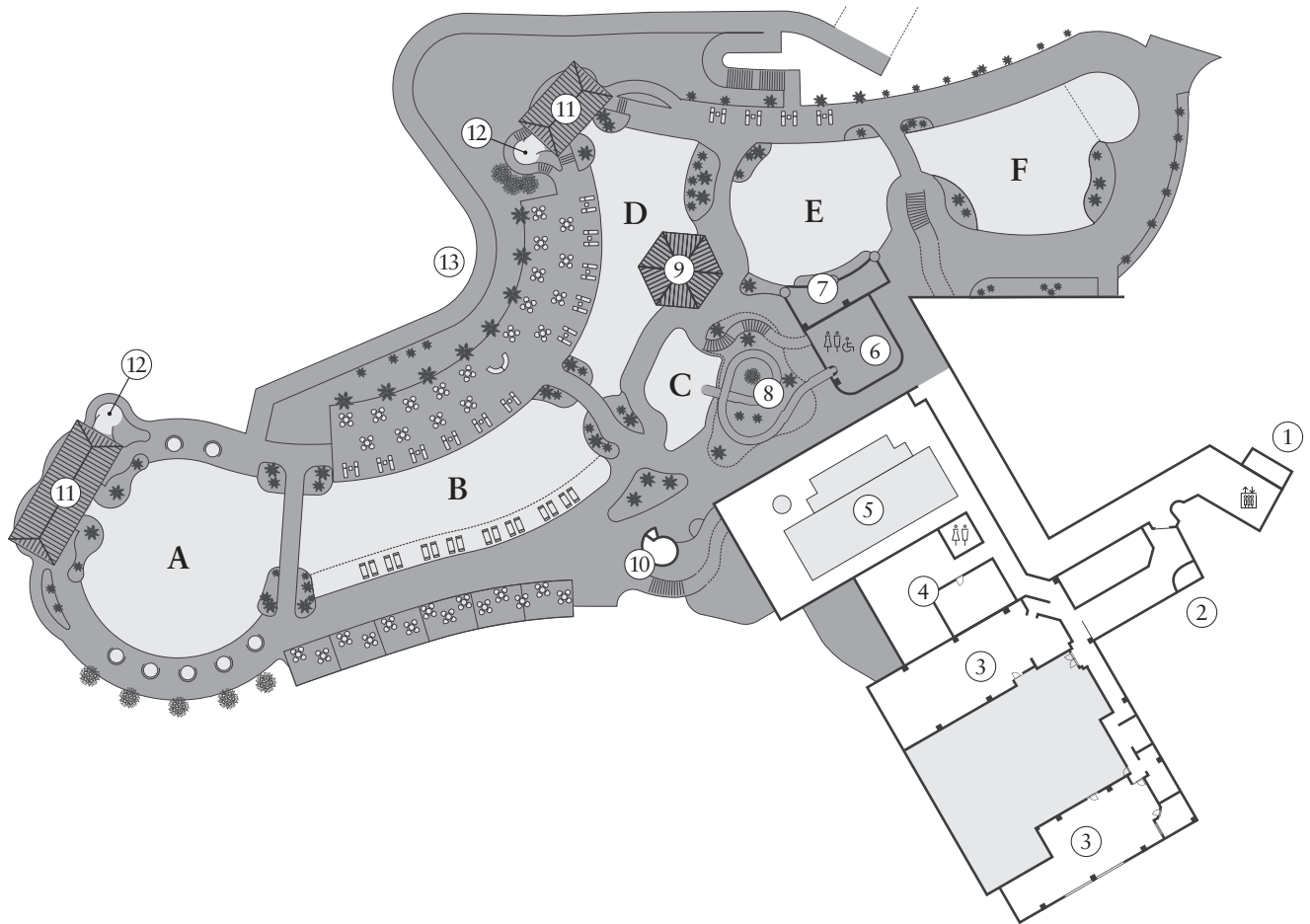

- | | | |
|-----------------|-------------------------|--------------|
| ① Laundry | ⑥ Garden Pool Reception | ⑪ Gazebo |
| ② Spa Reception | ⑦ Changing Room | ⑫ Vibra-Bath |
| ③ Spa | ⑧ Water Slide | ⑬ Walk Way |
| ④ Fitness Gym | ⑨ Pool Side Bar | |
| ⑤ Indoor Pool | ⑩ Sauna | |